

K-Conveyor Drive Pulley Worksheet

Kinder Reference Drawing: 1072

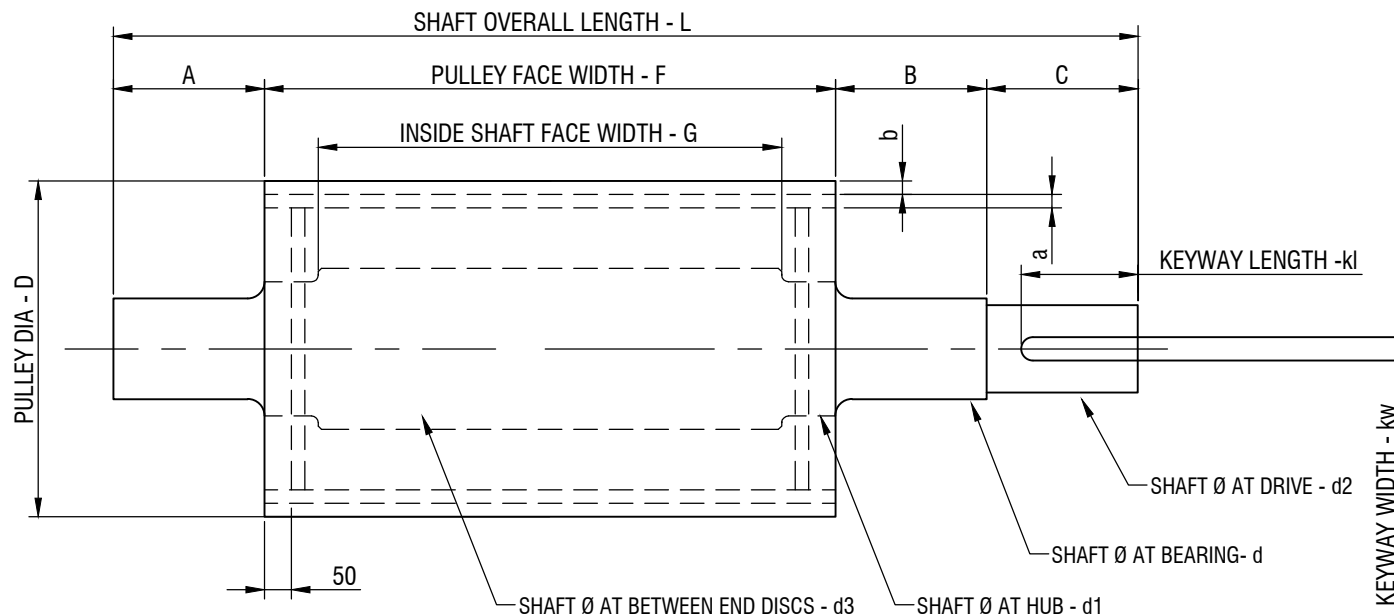

NOMINATE ANY SPECIAL SHAFT OR PULLEY REQUIREMENTS UPON ORDERING

ALL DIMENSIONS - mm

PULLEY :		SHAFT:	KEYWAY:	SHAFT ATTACHMENT:	LAGGING	YES	NO
OVERALL DIAMETER -D		DIA AT BEARING-d		WELDED TO PULLEY	<u>PULLEY WITH LAGGING:</u>		
PULLEY FACE WIDTH -F		DIA AT HUB-d1	KEYWAY WIDTH kw	LOCKING ELEMENT TO PULLEY	LAGGING THICKNESS-b		
SHAFT FACE WIDTH -G		DIA AT DRIVE-d2		TAPERLOCKED TO PULLEY	DIAMOND GROOVED		
SHELL THICKNESS -a		DIA AT BETWEEN DISCS-d3	KEYWAY LENGTH kl	OTHER	PLAIN FINISH		
CROWNED: YES NO		SHAFT LENGTHS: OVERALL LENGTH -L A. B C			CERAMIC		
SPEED - rev/min		BEARINGS with cylindrical bore					
		CODE:- with adapter sleeve					

Issue Date: 29/01/2013

K-WS-K-Conveyor Drive Pulley; Rev. 0;



Kinder Australia Pty Ltd

P | +61 3 8587 9111 F | +61 3 8587 9101 E | sales@kinder.com.au
26 Canterbury Rd, Braeside VIC 3195 (PO Box 1026, Braeside VIC 3195)

Subject to © Kinder Australia Pty Ltd



www.kinder.com.au

abn 28 006 489 238

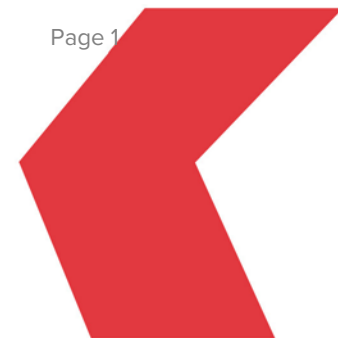

K-Conveyor Drive Pulley Worksheet

Name: _____

Company: _____

Site/Operation Location: _____

Contact Number: _____

Email: _____

Date: _____

Entered or Approved
by Kinder Employee: _____

Kinder Document ID: _____

K-WS-K-Conveyor Drive Pulley; Rev. 0;

Issue Date: 29/01/2013



abn 28 006 489 238

www.kinder.com.au



EXPERIENCE INNOVATION PRODUCTIVITY

Kinder Australia Pty Ltd

P | +61 3 8587 9111 F | +61 3 8587 9101 E | sales@kinder.com.au

26 Canterbury Rd, Braeside VIC 3195 (PO Box 1026, Braeside VIC 3195)

Subject to © Kinder Australia Pty Ltd

Page 2

